

All structures shall be manufactured industrially in an appropriately certified company in compliance with: LVS EN 1090: 1;

- Welding of steel structures in accordance with LVS EN 1011 and LVS EN 3834 standards;

Conformity of production must be certified in accordance with LVS EN 45014;

- Construction production category PC2, execution class EXC2;

- Welding of structures at the factory shall be performed according to the welding procedure developed by the manufacturer specifications. The welds of the welded joints shall be formed along the contact length of elements, assuming that the thickness of the corner seam (leg length) cannot exceed  $a = 0.85 (z = 1.2)$  of the thickness of the thinnest element (unless otherwise indicated in the drawings);

- Butt welds must have 100% penetration.

- The steel grade must comply with S355J2 according to EN 1993-1-1 and according to EN 10025-2;

- Geometry of IPE profiles according to EN 19-57;

- Geometry of HEA profiles according to EN 53-62;

- U-profile geometry according to EN 10279;

- Geometry of RHS pipe profiles according to EN 10219-2;

- Geometry of SHS pipe profiles according to EN 10219-2;

- Sheets according to EN 10029.

-For all metric thread fasteners, use Loctite 243 threadlocker on final assembly.

NO.	PART NO	DESCRIPTION	MATERIAL	PROCESSING	REVISION	WEIGHT	QTY
1	105-03001-00	Short Beam 1	-	WLD HDG		39.28	1
2	105-03002-00	Short Beam 2	-	WLD HDG		42.16	1
3	105-03003-00	Short Beam 3	-	WLD HDG		39.28	1
4	105-03004-00	Short Beam 4	-	WLD HDG		42.08	1
5	105-03005-00	Long Beam 1	-	WLD HDG		240.28	1

NO.	PART NO	DESCRIPTION	MATERIAL	PROCESSING	REVISION	WEIGHT	QTY
6	105-03006-00	Long Beam 2	-	WLD HDG		235.65	1
7	105-03007-00	Lower Beam 1-1	-	WLD HDG		296.23	1
8	105-03008-00	Lower Beam 1-2	-	WLD HDG		71.15	1
9	105-03009-00	Lower Beam 2-1	-	WLD HDG		288.00	1
10	105-03010-00	Lower Beam 2-2	-	WLD HDG		70.35	1
11	105-03011-00	Upper Beam 1-1	-	WLD HDG		265.83	1
12	105-03012-00	Upper Beam 1-2	-	WLD HDG		63.98	1
13	105-03013-00	Upper Beam 2-1	-	WLD HDG		265.94	1
14	105-03014-00	Upper Beam 2-2	-	WLD HDG		64.97	1
15	105-03015-00	Lateral Beam 1	-	WLD HDG		110.09	2
16	105-03016-00	Lateral Beam 2	-	WLD HDG		110.09	2
17	105-03017-00	Lateral Beam 3	-	WLD HDG		110.09	2
18	105-03018-00	Lateral Beam 4	-	WLD HDG		135.81	1
19	105-03019-00	Lateral Beam 5	-	WLD HDG		104.94	1
20	105-03020-00	Lateral Beam 6	-	WLD HDG		66.81	1
21	105-03021-00	Brace 1	-	WLD HDG		21.96	1
22	105-03022-00	Brace 2	-	WLD HDG		31.39	1
23	105-03023-00	Brace 3	-	WLD HDG		34.39	2
24	105-03024-00	Brace 4	-	WLD HDG		33.27	2
25	105-03025-00	Pillar - Corner	-	WLD HDG		41.67	4
26	105-03026-00	Pillar	-	WLD HDG		43.64	8
27	105-03027-00	Pillar with Fixture	-	WLD HDG		47.84	2
28	105-03028-00	Diagonal 1	-	WLD HDG		56.58	2
29	105-03029-00	Diagonal 2	-	WLD HDG		48.58	4
30	105-03030-00	Diagonal 3	-	WLD HDG		56.11	2
31	105-03031-00	Diagonal 4	-	WLD HDG		52.71	2
32	105-03032-00	Diagonal 5	-	WLD HDG		50.92	2
33	105-03033-00	Diagonal 6	-	WLD HDG		61.52	1
34	105-03034-00	Upper Lateral Beam	-	WLD HDG		54.08	5
35	105-03035-00	Diagonal 7	-	WLD HDG		58.32	2
36	105-03036-00	Diagonal 8	-	WLD HDG		62.04	1
37	105-03037-00	Diagonal 9	-	WLD HDG		59.03	1
38	105-03038-00	Diagonal 10	-	WLD HDG		55.34	1
39	105-03039-00	Extra Diagonal	-	WLD HDG		45.75	4
40	105-03041-00	Brace 5	-	WLD HDG		56.34	1
41	105-03000-01	Entrance Zone Bracket	S355J2	LC HDG		4.11	2
42	105-03000-02	Back Plate 1	S355J2	LC HDG		1.11	2
43	105-03000-03	Glass Support bracket	S355J2	LCB HDG		0.91	1
44	105-03000-04	Back Plate 2	S355J2	LC HDG		0.30	2
45	105-03000-05	Panel bracket 2-1	S355J2	LCB HDG		15.87	1
46	105-03000-06	Panel bracket 2-2	S355J2	LCB HDG		9.85	2
47	105-03000-07	Panel bracket 2-3	S355J2	LCB HDG		10.87	1
48	105-03000-08	Panel bracket 2-4	S355J2	LCB HDG		10.87	1
49	105-03000-09	Panel bracket 2-5	S355J2	LCB HDG		11.24	1
50	105-03000-10	Panel bracket 1-1	S355J2	LCB HDG		13.26	1
51	105-03000-11	Panel bracket 1-2	S355J2	LCB HDG		8.22	2
52	105-03000-12	Panel bracket 1-3	S355J2	LCB HDG		9.07	1
53	105-03000-13	Panel bracket 1-4	S355J2	LCB HDG		9.07	1
54	105-03000-14	Panel bracket 1-5	S355J2	LCB HDG		9.39	1
55	Loctite 243	Threadlocking adhesive medium strength 130ml	-	COTS		0.00	1
56	ISO4017 (DIN933) M10x30	Hex bolt	HDG-8.8	COTS		0.03	80
57	ISO4014 (DIN931) M12x150	Hex bolt with shank	HDG-8.8	COTS		0.15	10
58	SB EN 15048-1 ISO4014 (DIN931) M12x45	SB Hex bolt with shank	HDG-8.8	COTS		0.06	32
59	SB EN 15048-1 ISO4014 (DIN931) M16x60	SB Hex bolt with shank	HDG-8.8	COTS		0.13	148
60	SB EN 15048-1 ISO4014 (DIN931) M16x70	SB Hex bolt with shank	HDG-8.8	COTS		0.15	16
61	SB EN 15048-1 ISO4014 (DIN931) M20x70	SB Hex bolt with shank	HDG-8.8	COTS		0.24	64
62	SB EN 15048-1 ISO4017 (DIN933) M12x40	SB Hex bolt	HDG-8.8	COTS		0.05	28
63	DIN7349 M10	Thick washer	HDG-HV200	COTS		0.01	80
64	ISO7089 (DIN125) M10	Plain Washer	HDG-HV200	COTS		0.00	80
65	ISO7089 (DIN125) M12	Plain Washer	HDG-HV200	COTS		0.01	140
66	ISO7089 (DIN125) M16	Plain Washer	HDG-HV200	COTS		0.01	328
67	ISO7089 (DIN125) M20	Plain Washer	HDG-HV200	COTS		0.02	128
68	ISO4032 (DIN934) M10	Hex nut	HDG-8	COTS		0.01	80
69	ISO4032 (DIN934) M12	Hex nut	HDG-8	COTS		0.02	10
70	SB EN 15048-1 ISO4032 (DIN934) M12	SB Hex nut	HDG-8	COTS		0.02	60
71	SB EN 15048-1 ISO4032 (DIN934) M16	SB Hex nut	HDG-8	COTS		0.04	164
72	SB EN 15048-1 ISO4032 (DIN934) M20	SB Hex nut	HDG-8	COTS		0.07	64

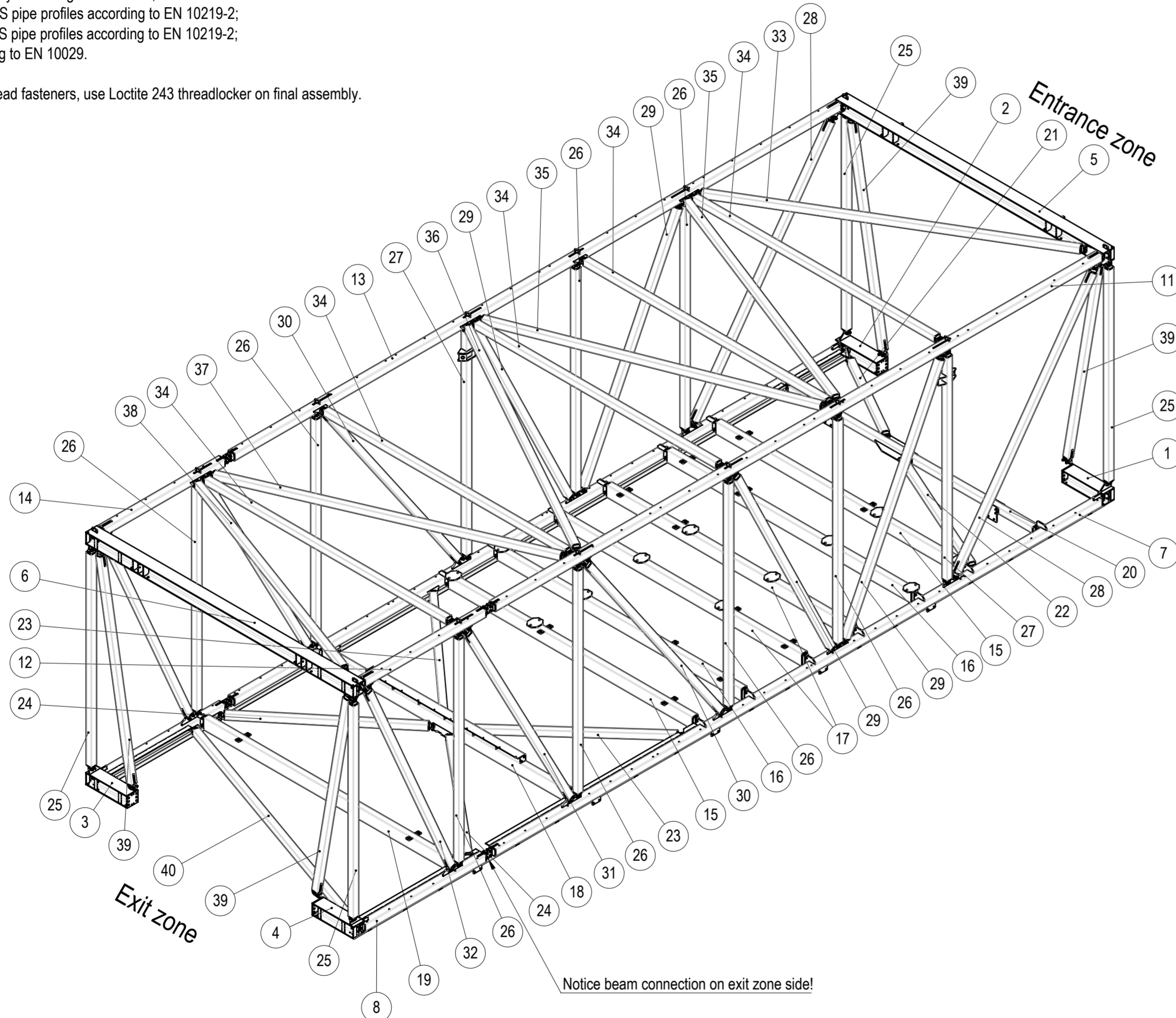

Note:  
Positions 41 ; 42 ; 43 & 44 must be installed after ceiling sound insulation panel installation

<b>WEMPS</b> ENGINEERING SERVICES		MATERIAL	WEIGHT	DEBURR AND BREAK SHARP EDGES DO NOT SCALE DRAWING	REVISION	DATE
		SURFACE PROTECTION	MACHINING	THERMAL CUTTING	WELDING	SCALE   FORMAT
		-	ISO 2768 mK	ISO 9013 221	ISO 13920 BF	1:50   A2
NAME	SIGNATURE	PART NO.		105-03000-00		
Designed by	A. Menkins	DESCRIPTION		Bearing frame		
Drawn by	D. Dislers	PART NO.		105-03000-00		
Technical ref		DESCRIPTION		Bearing frame		
						SHEET 1/3



J-J  
SCALE: 1 : 30

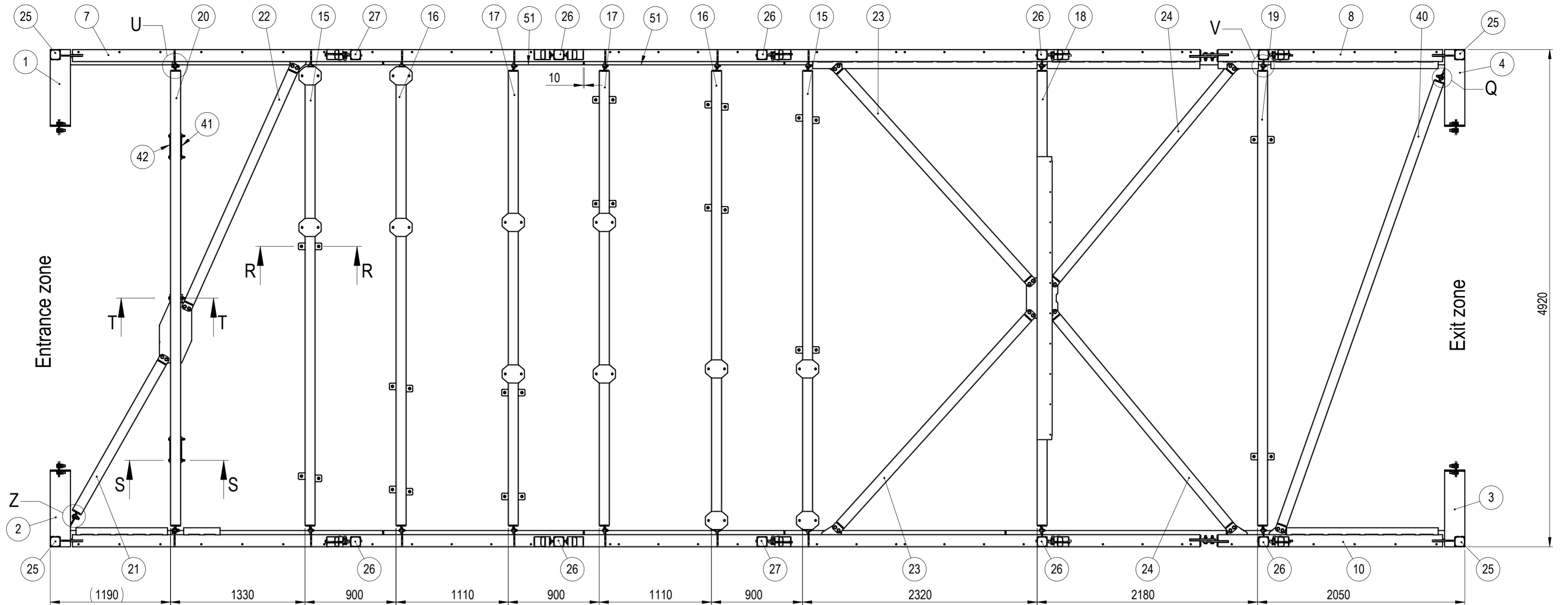

Lateral Beams (Pos. 15, 16, 17, 18 & 19) must be attached to the Lower beams from Left side - according to J-J drw. view. - See Detail view V.

Lateral Beam (Pos. 20) must be attached to the Lower beams from Right side - according to J-J drw. view. - See Detail view U.

K  
SCALE: 1 : 10

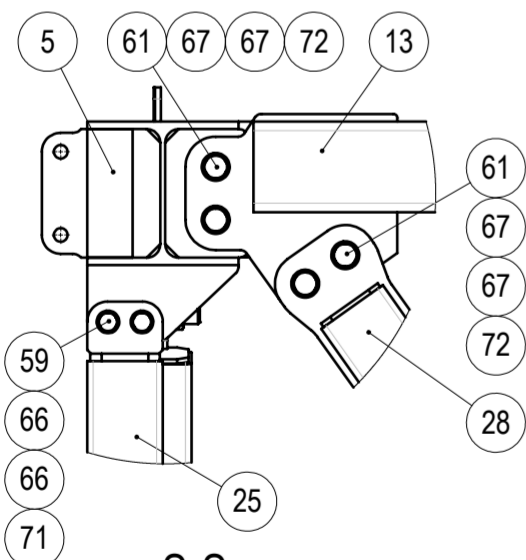

L  
SCALE: 1 : 10

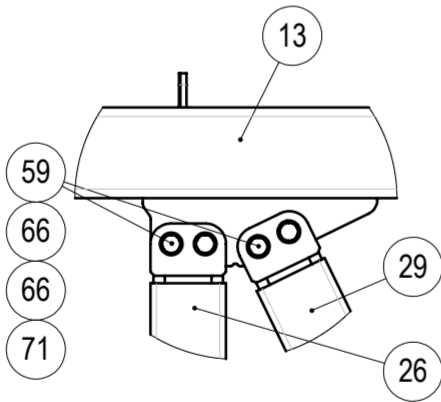

M  
SCALE: 1 : 10

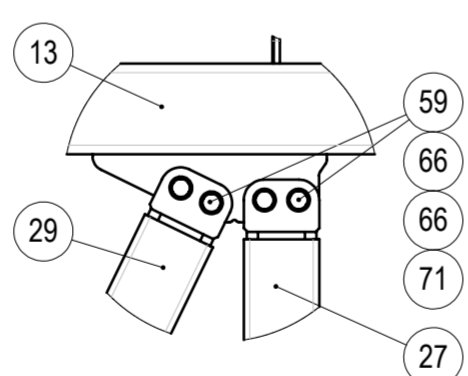

N  
SCALE: 1 : 10

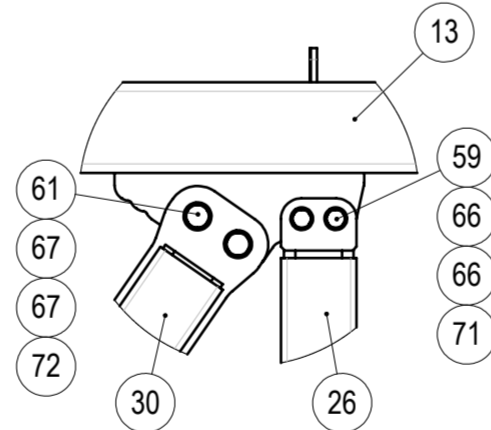

O  
SCALE: 1 : 10

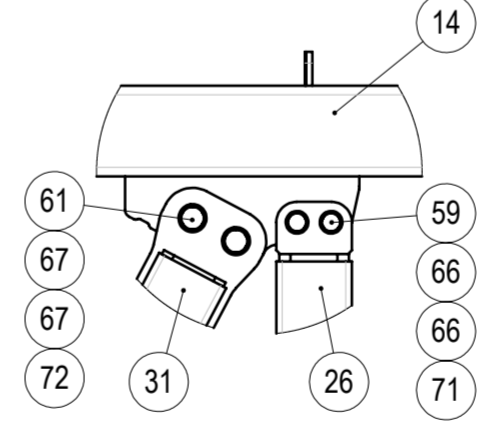

P  
SCALE: 1 : 10

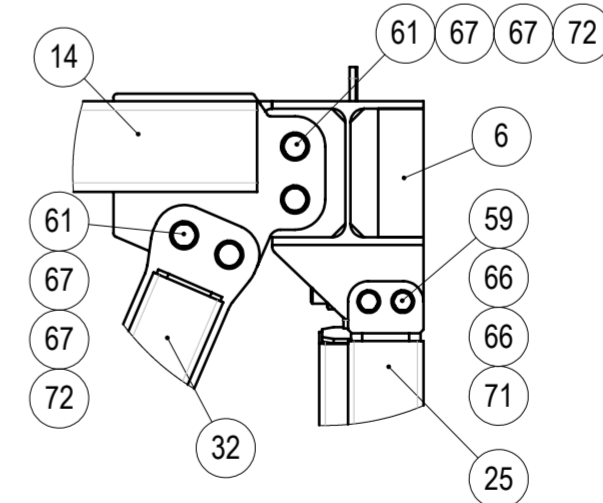

Q  
SCALE: 1 : 5

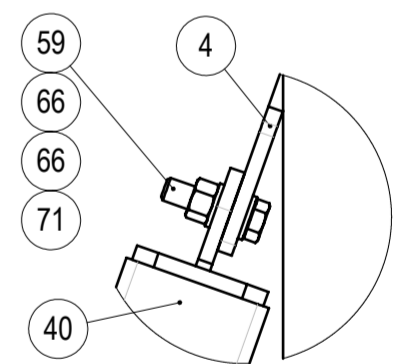

R-R  
SCALE: 1 : 5

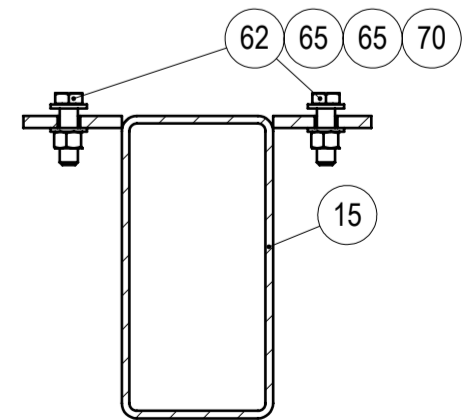

S-S  
SCALE: 1 : 5

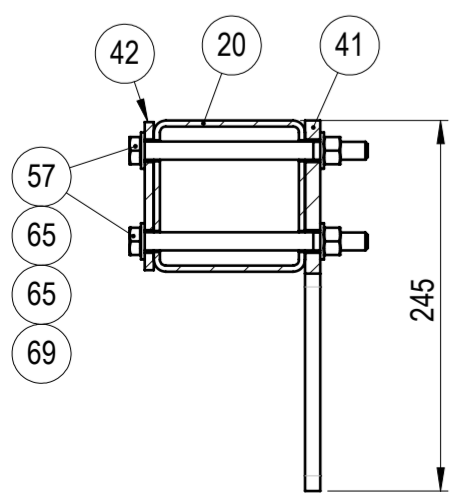

T-T  
SCALE: 1 : 5

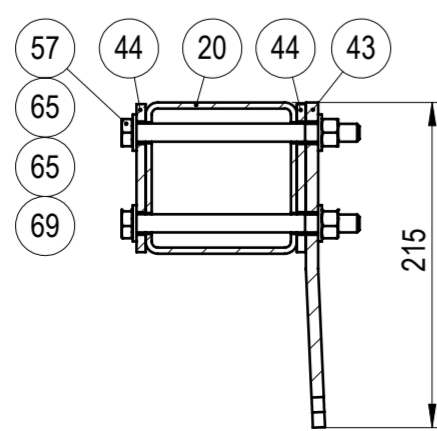

U  
SCALE: 1 : 5

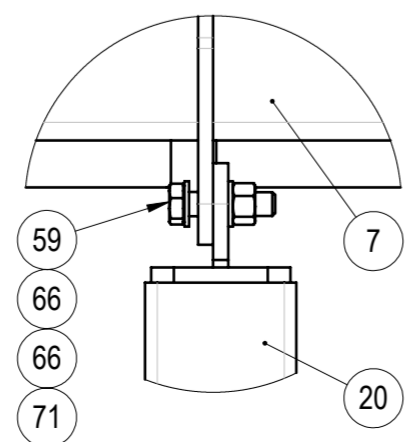

V  
SCALE: 1 : 5

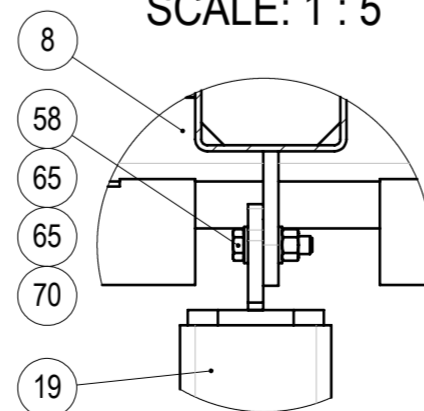

Z  
SCALE: 1 : 5

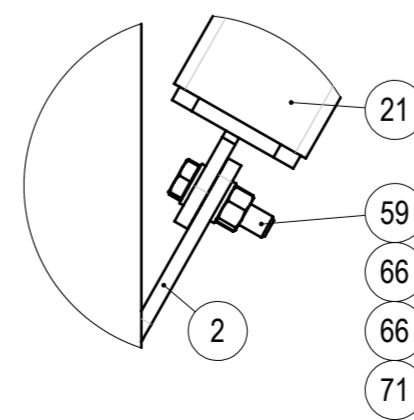

All Pillars and vertical Diagonals must be flush with Lower and Upper diagonals (same applies for Ceiling diagonals and Upper diagonals)

		MATERIAL	WEIGHT	DEBURR AND BREAK SHARP EDGES	REVISION	DATE
		-	5487.885 Kg	DO NOT SCALE DRAWING		08.05.2026
Designed by A. Menkins Drawn by D. Dislers Technical ref.		SURFACE PROTECTION	MACHINING	THERMAL CUTTING	WELDING	SCALE
		-	ISO 2768 mK	ISO 9013 221	ISO 13920 BF	1:50
		PART NO.	105-03000-00			
		DESCRIPTION	Bearing frame		SHEET 3/3	